



# 12,1" Innomag<sup>®</sup> String Magnet

Model IM 102

For cleaning out 13 3/8" casing, NC 50 box x pin connection

Dimensional data	
Max OD, inch	12.1
Min ID, inch	3,00
Fish neck OD, inch	6,500
Length, mm	2003
Material properties	
Body material	AISI 4145
Tensile Yield strength, lbs	1 030 000
Torisional Yield strength, ft-lbs	25 000 *)
Magnet Ribs on stabilizer	5
Magnet type	Innovar specified
Operational data	
Flow by area, sq.in	30,2 **)
Magnetic field effective reach, inches	18
Connection	NC 50
Max rotation, rpm	120
Transport Data	
Weight, kg	300

\*) This is for internal compressional loads due to the internal threads . For twist off, the Tool Joint is the weakest member.

\*\*) inside 13 3/8", 72 #/ft casing

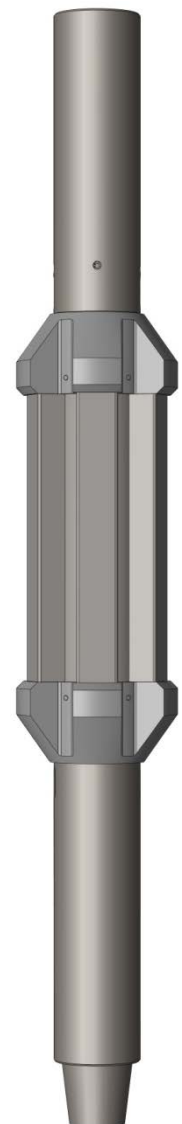

Updated electronic revision of this document is filed at <http://www.innovar.no>